

# SIGMA<sup>LT</sup> Control

## HAND-HELD QUICK-START GUIDE

### KEY:

#### LOAD SELECTION

- Decrease Load
- Increase Load
- 0** Manual Load Entry
- OK
- Apply Load
- Reject Load

#### NAVIGATION

- Next Screen
- Down Screen
- Back Screen
- Network Overview
- Network Search
- Settings
- Status - Load Off
- Status - Load On
- Status - Warning
- Status - Error

1: 0/100 kW Single Load Bank Control

#### OTHER SYMBOLS

- #1** Load Bank ID (Network view only)
- USB Found



### WARNING!

READ THE LOAD BANK MANUAL BEFORE USE AND TAKE SPECIAL NOTE OF ALL SAFETY WARNINGS.

KEEP PEOPLE WELL AWAY. CLOSE ALL DOORS. ENSURE CABLES AND EARTHING ARE ADEQUATE. ENSURE A 4M GAP IS BETWEEN LOAD BANKS TO PREVENT HOT AIR RECIRCULATION. RISKS INCLUDE FIRE AND BURNS FROM THE HOT AIR OUTLET AND ELECTRIC SHOCK.

## LOAD CONTROL

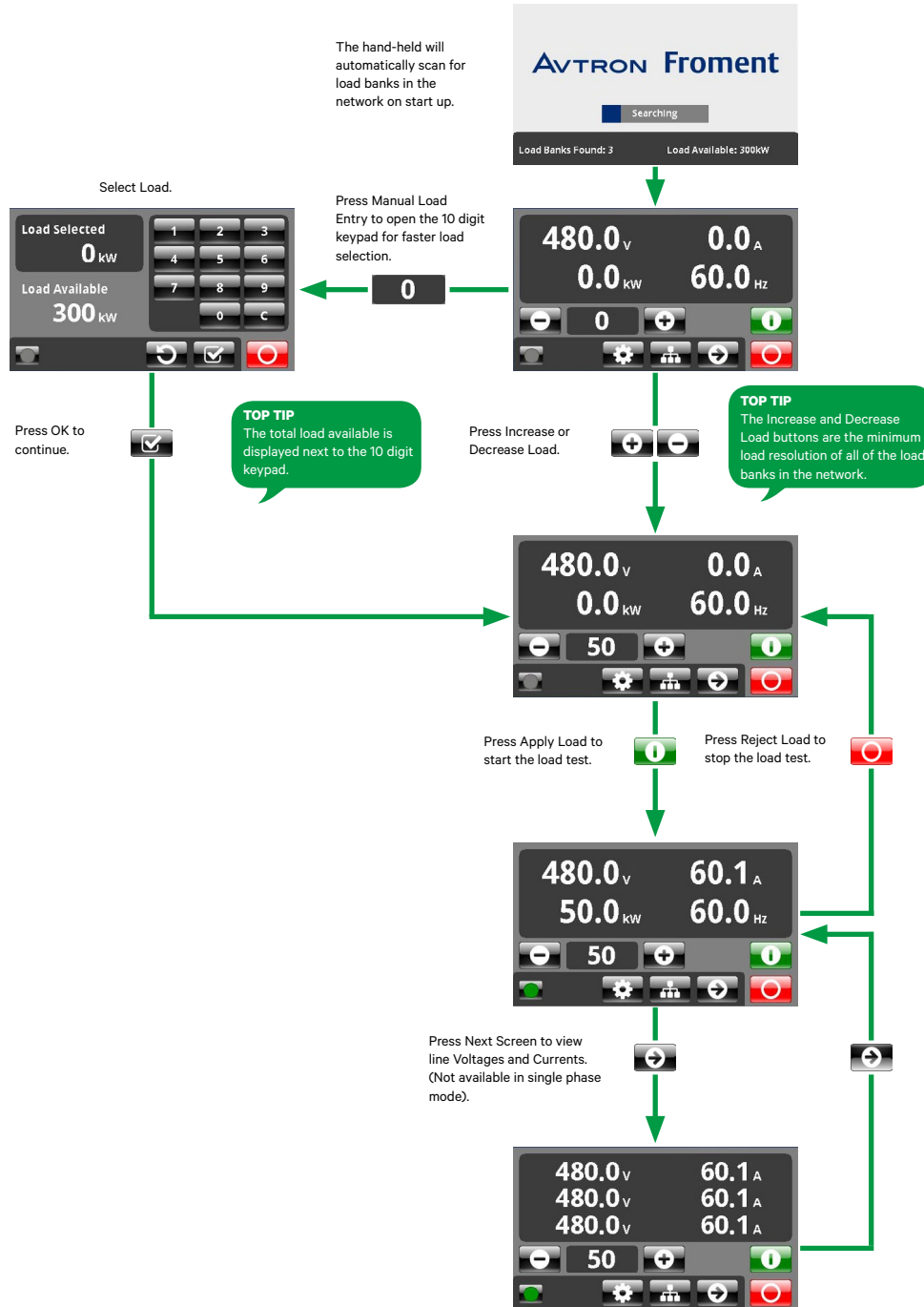

## DATA LOGGING

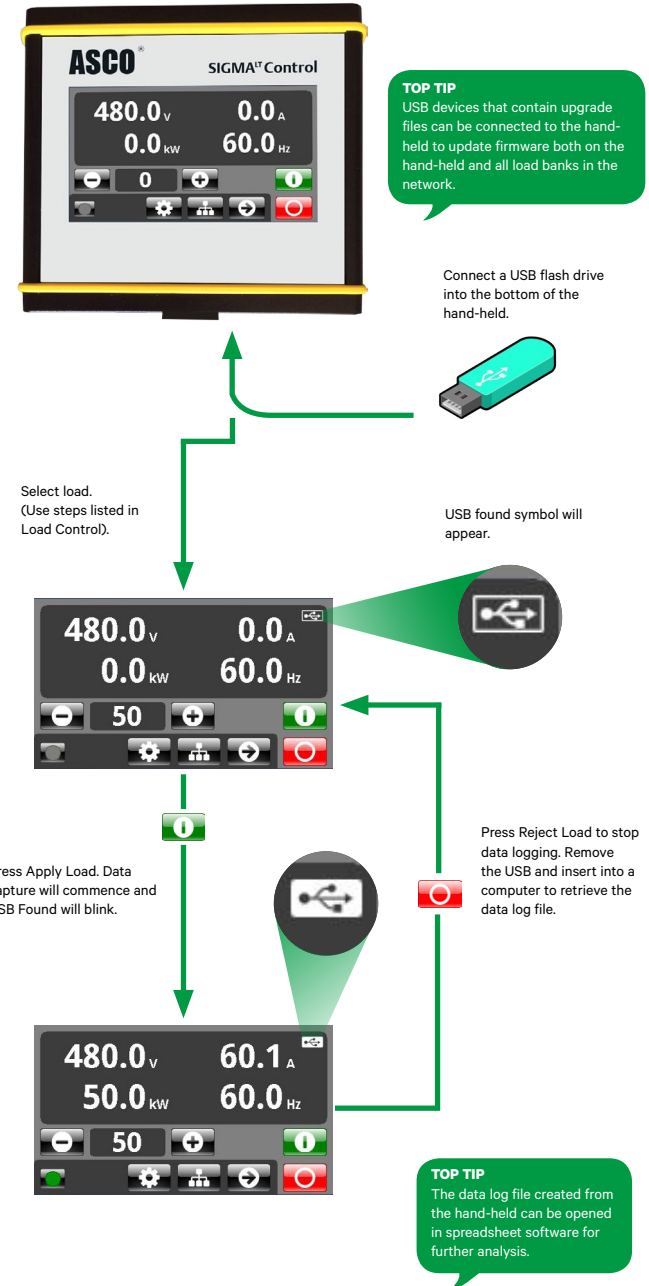

## LOAD BANKS IN A NETWORK

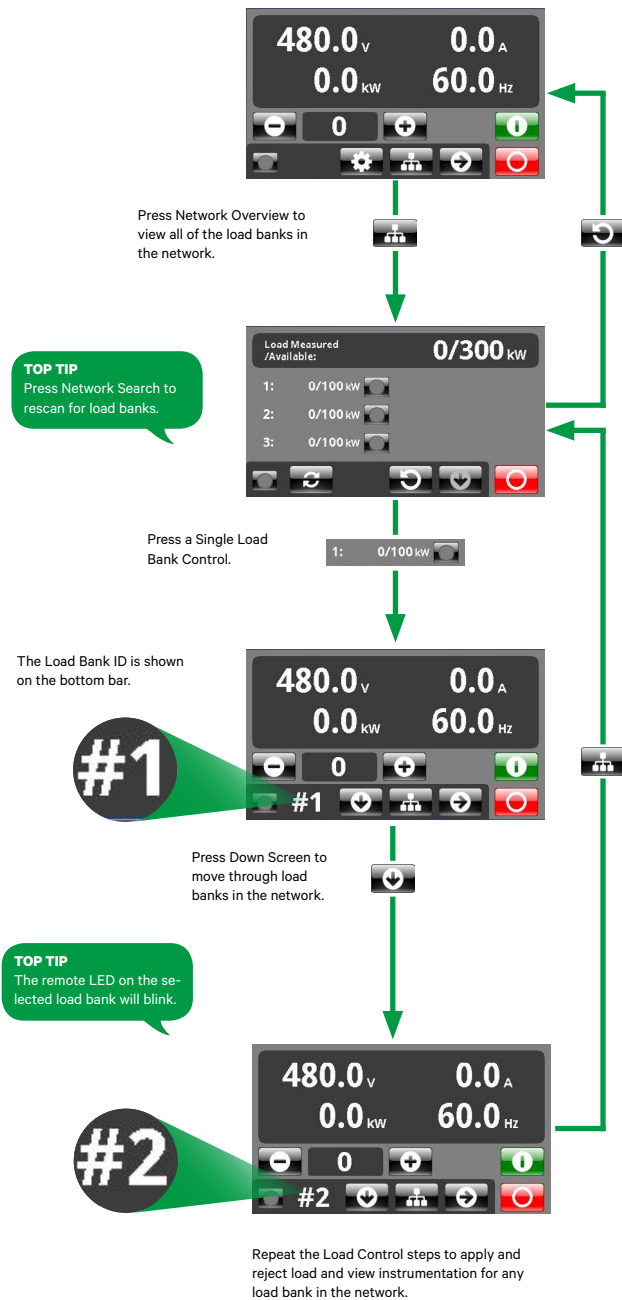

## STATUS

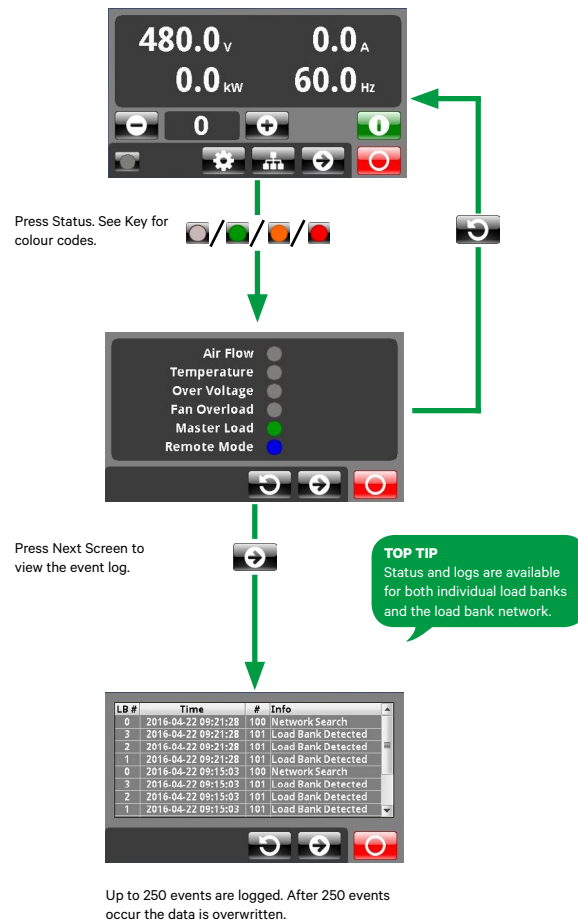

## SETTINGS

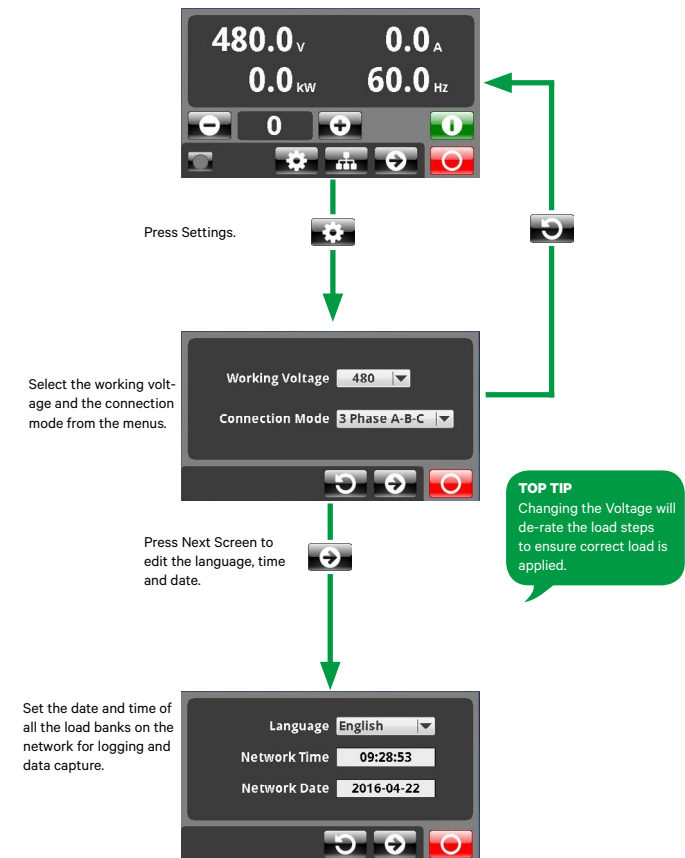

## ERRORS

